

introducing the

'EDGE' Air

opening flat rooflight

edge-to-edge glass technology

www.titanaluminium.co.uk



TITAN
ALUMINIUM

The 'EDGE' Air flat rooflight comes with the same superior specification as the Titan 'EDGE' with the added benefit of a manual or electric opening.

design

With a unique and polished edge-to-edge glass exterior, it's not only a stunning evolution of its rivals, but brings many practical benefits. Its clever design allows water to simply glide off its surface and not be hindered by perimeter sealants or protruding frames.

The intelligently concealed actuator is almost silent with its 'soft start' and 'soft close' operation. The 'EDGE' Air rooflight will open to a maximum of 300mm, and can either be operated by a wall mounted switch or a remote control. Additional options include rain sensor and thermostatic controls to automatically close when rain is detected.

Also available with manual winder and pole.

With its ultra low-profile design, the 'EDGE' Air stands only 103mm high. It's only 40mm higher than its sister product the Titan 'EGDE' allowing you to install them side by side with very little height difference.

benefits:

- Ultra-low profile
- 300mm opening max
- Integral motor
- Remote-controlled opening
- Quiet running actuator
- Minimum pitch: 5 degrees
- Maximum pitch: 45 degrees

sizes:

- minimum size: 450mm x 450mm
- maximum size: 1000mm x 2500mm
- minimum width: 450mm
- maximum weight: 160kg



thermally efficient

Whilst allowing maximum light to flood in, the 'EDGE' Air effortlessly allows to keep the unwanted heat out and the ambient room temperature constant giving you the benefit on year-round comfort and performance.

The 'EDGE' Air has a very careful selection of high performance glazing components. It benefits from both low maintenance solar reflective glass outside and low emission laminated glass inside, structurally bonded into the unique super-slim edge thermally broken aluminium frame providing all-year-round comfort with a typical U-Value of 1.3 w/m²k (overall roof).

security

The 'EDGE' Air is fixed internally by way of pre-fitted strap fixings.

A very welcomed standard feature of the 'EDGE' Air is laminated security glass to the inner panel. The shatterproof laminated glass is included as standard and provides homeowners with safety, security, noise reduction, and **98%** reduction in UV rays which prevents sun bleaching.

This addition gives you peace of mind as it's very difficult to penetrate from the outside as well as the inner panel is shatterproof laminated glass is so provides optimum safety.

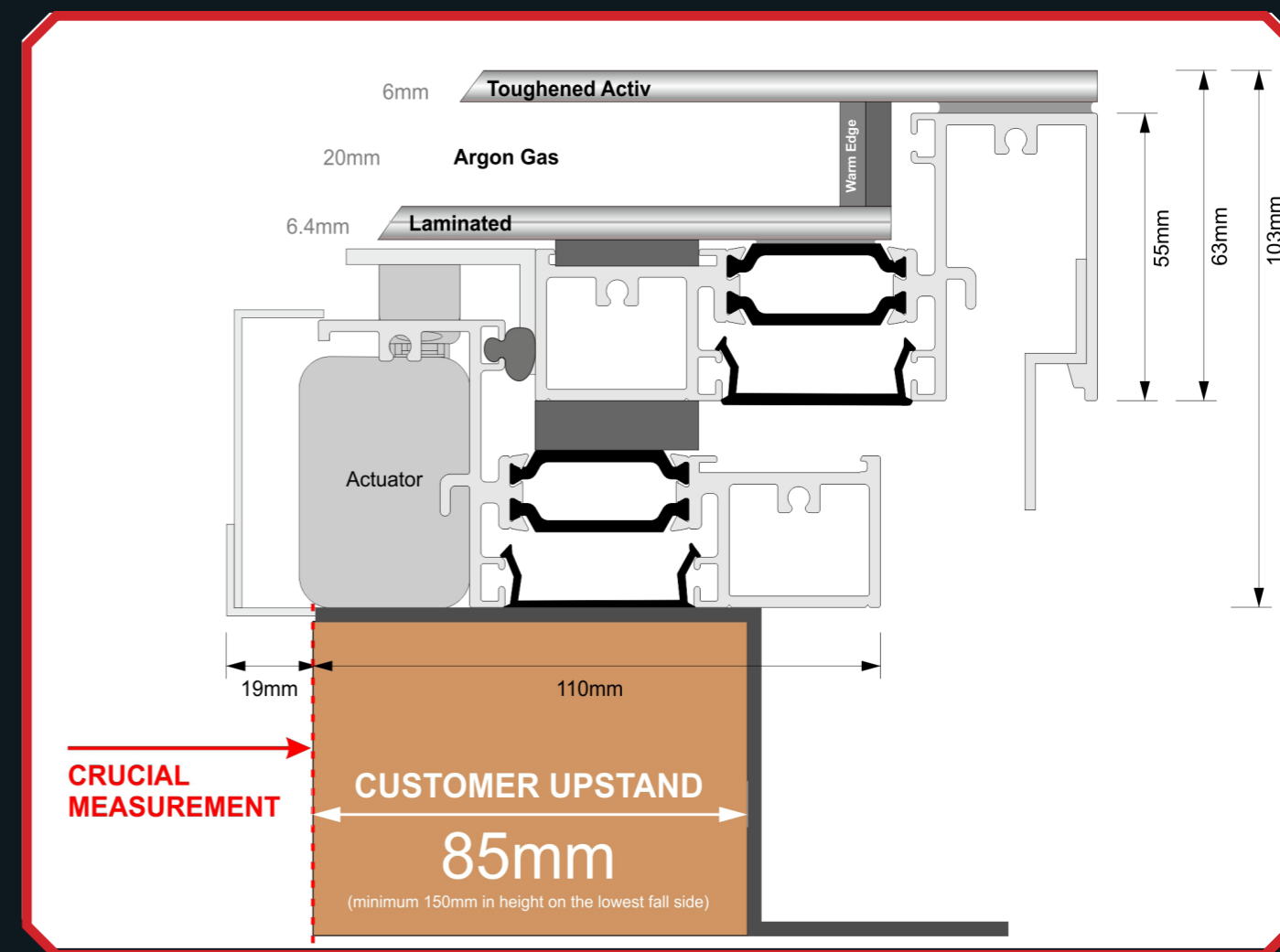

Get a quote today

01256 760070

sales@titanaluminium.co.uk

www.titanaluminium.co.uk



TITAN
ALUMINIUM